



**M. R. SUDIPTA KUMAR SARKAR**  
SERVEYOR & CONSULTANT ENGINEER  
L.B.S. KOLKATA MUNICIPAL CORPORATION  
LICENSE NO-1737, CLASS-I

OFFICE:35C,Jogendra Basak Road,Kolkata-700090.  
MOB : 9593281247 & 7980411936.  
EMAIL :sudeep92.engcivil@gmail.com.

DT: 25/01/2024

Ref:-

### Certificate

**Premises No: 31/2E, Beerpara Lane , Kolkata-700030, Ward No-004, Borough No-I, P.S-  
Chitpur , Under The Kolkata Municipal Corporation.**

Assessee No : 110040200629  
Name of the Owner(s) / Applicant(s) : Dilip Kumar Shaw, Pintu Kumar Shaw, &  
Nilam Gupta  
Area of Land as per deed : 336.308 sq.m.  
Name of LBS/Architect : Sudipta Kumar sarkar No: 1737 / I  
Permissible height in reference to CCZM issued by AAI: 33.0 M.  
**Co-ordinate in WGS 84 and site elevation (AMSL): - 7.0 M.**  
Proposed building height including mumty room & overhead tank: - (7.0+15.475+4.650)  
= 27.125 M.

Reference point marked in the site plan of the proposal	Co-ordinate in WGS 84		Site Elevation
	Latitude	Longitude	
"A"	22.3954	88.2407	7.0 M.

Counter signed by

Owner(s)/Applicant(s)

  
**SUDIPTA KUMAR SARKAR (B.Tech)**  
Surveyor & Consultant Engineer  
L.B.S.Kolkata Municipal Corporation  
Licence No. 1737 Class- I  
E-mail : -Sudeep92.engcivil@gmail.com  
Signature of LBS / Architect

Planner, Designer, Estimator, surveyor & Consultant Engineer



PROPOSED PLAN OF G+IV(FOUR) STORIED RESIDENTIAL BUILDING OF HEIGHT-15.475 M. FOR SANCTION U/S-393(A) OF K.M.C. ACT-1980 & K.M.C. BLDG. RULE 2009 , AT PREMISES NO-31/2E,BEERPARA LANE, KOLKATA-30, WARD NO - 004, P.S. - CHITPUR, BOROUGH - I, UNDER THE KOLKATA MUNICIPAL CORPORATION, ASSESSEE NO-110040200629.

AREA OF LAND AS PER DEED (05 K.-00 CH.- 30 SFT) =337.235 SQ.M.  
 AREA OF LAND AS PER BOUNDARY DECL. (05 K.-00 CH.-20.019 SFT.) =336.308 SQ.M.

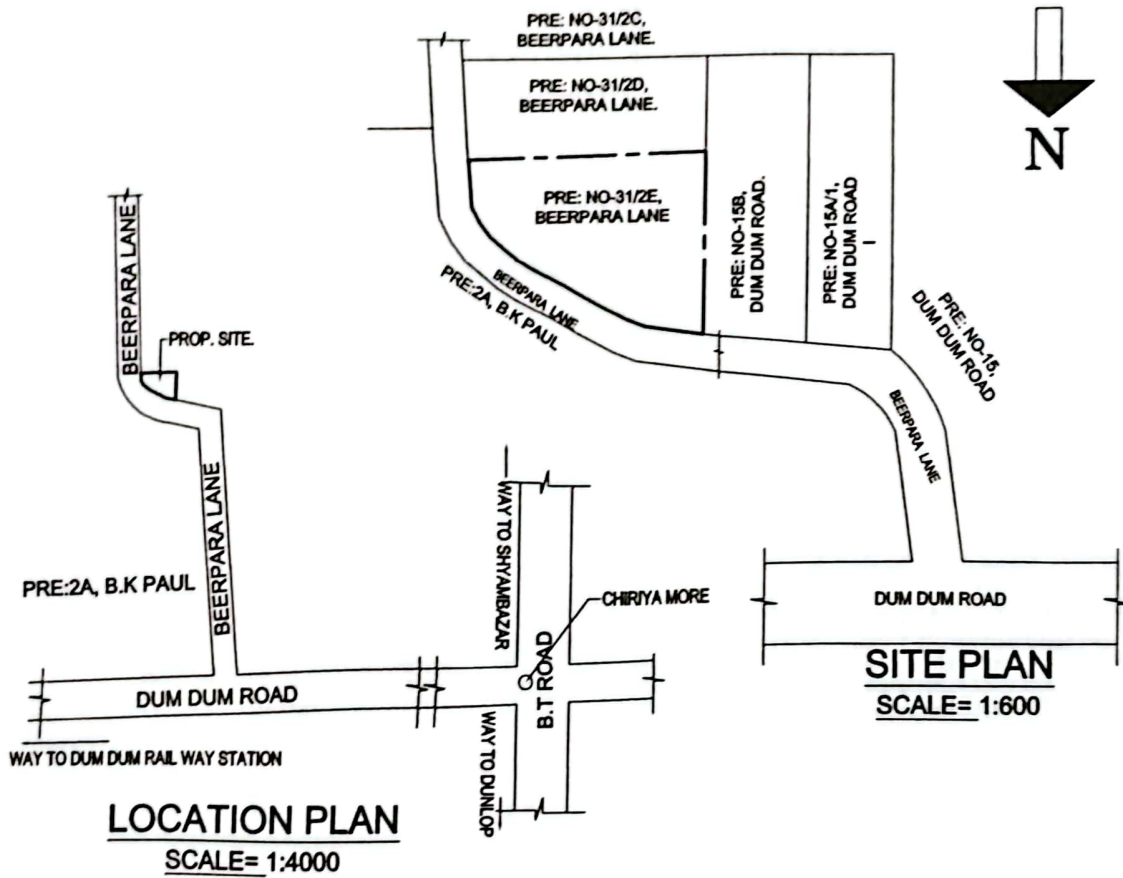

*Sudipta Kumar Sarkar*  
**SUDIPTA KUMAR SARKAR (B.Tech)**  
 Surveyor & Consultant Engineer  
 L.B.S. Kolkata Municipal Corporation  
 Licence No. 1737 Class- I  
 E-mail : -Sudeep92.engcivil@gmail.com

Planner, Designer, Estimator, surveyor & Consultant Engineer

**SIGNATURE OF OWNER/APPLICANT**

**SIGNATURE OF L.B.S.**